

IntelliSuite: an end-to-end solution for MEMS design and simulation

ABOUT

Attend informative IntelliSuite training workshops with the Australian National Fabrication Facility (ANFF). These hands-on sessions will introduce cutting-edge methodology and tools for MEMS/NEMS design, analysis, fabrication simulation, and more. Attendees will learn more about the IntelliSuite family of tools, view live demonstrations, get a first look at the newest software version, and have the opportunity to try some hands-on tutorials.

SESSIONS

Information session

Mon 7 December, 10am - 1pm
Level 4 meeting room,
Australian Institute for Bioengineering & Nanotechnology
Building 75, The University of Queensland
St Lucia QLD 4072

Training workshop

Tue 8 December & Wed 9 December, 10am - 4pm
Room 241, Sir James Foots Building
Building 47A, The University of Queensland
St Lucia QLD 4072

Training workshop

Thu 10 December & Fri 11 December, 10am - 4pm
Future Industries Institute
Building MM
University of South Australia
Mawson Lakes SA 5001

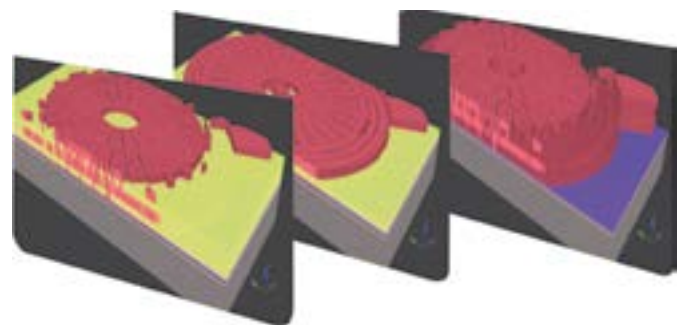
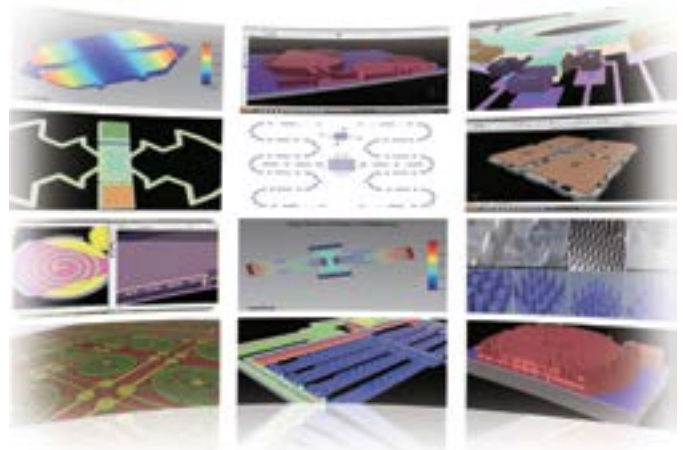

ANFF Design House will cover the cost of flights to and from the workshops for interstate ANFF staff. Each node should provide a single invoice for their participants' flight expenses. To register, simply email shan.don@monash.edu



SPEAKER

Tom Hall is the Applications Manager for IntelliSense. He has extensive CAD expertise and a strong background in TCAD, CAM, EDA and FEA software. Since joining IntelliSense in 2012, Tom has worked with current and prospective software users, both in industry and academia, to determine their latest needs and then identify appropriate solutions with IntelliSuite. He has led several on-site and web-based training workshops for users, locally and globally. Tom holds a degree in Mechanical Engineering with a concentration in Manufacturing Engineering from Boston University.